

Traveling to Madison

Direct Flights into Madison

Madison is served by the **Dane County Regional Airport (MSN)**, which handles more than 75 daily flights. Major airports with nonstop flights to Madison include Chicago-O'Hare, Milwaukee, St. Louis, Minneapolis, Detroit, Cincinnati, Denver, and Washington-Reagan. The commercial air carriers that offer service from the Dane County Regional Airport are:

- **American Eagle** (American) - www.aa.com
- **Comair** (Delta) - www.comair.com
- **Continental Express** (Continental) - www.continental.com
- **Midwest Airlines** - www.midwestairlines.com
- **Northwest** - www.nwa.com
- **United Express** (United) - www.united.com

A taxi from the airport to the downtown/campus area is about a 15-20 minute ride (except during rush hour) and will cost around \$25. If you are coming from outside the U.S. and have to buy a separate ticket to Madison, you might consider taking the bus from O'Hare airport in Chicago.

Transportation by Bus from Chicago-O'Hare

Busses between Madison and Chicago O'Hare/downtown Amtrak station are operated by the **Van Galder Bus Company**. They depart approximately every 30 to 90 minutes from International Terminal #5 (Lower Level, Exit 5E), and 30 minutes later from the Bus/Shuttle Center outside Terminals 1-3. The bus trip to Madison takes about 3.5 hours and costs \$27 each way. It will drop you off at the **Memorial Union, 800 Langdon Street**, which is only 100m from the Pyle Center (the workshop venue).

For information and the bus schedule, visit the **Van Galder Bus Company web site** or call 800-747-0994, toll-free in the U.S.

Transportation by Bus from Minneapolis-St. Paul

If you are traveling from Minneapolis, check the **Greyhound Bus Company web site** or call Greyhound Bus (800-231-2222)

Taxi Service within Madison

There are several taxi companies in Madison which provide service between Dane County Airport and the Capitol Square, where the hotel is located, or the UW Pyle Center, where the meeting will be held. If requested in advance, several of these companies will also drive to the Milwaukee or Chicago airports for a fixed fee.

From Dane County Airport:

There is a taxi holding area in Dane County Airport at the exit of the baggage claim, and taxis should be available at all hours. If not, a taxi can be called from the airport information desk near the baggage claim. The fare to the city center will be about \$25.

To Dane County Airport:

Taxi pickups can be arranged at the hotel or the UW Pyle Center by calling a taxi service. If you do not arrange for pick-up at a set time, plan ahead for a wait of 15-20 minutes before the taxi arrives. Travel to the airport should take about 20 minutes from the Capitol Square and 25-30 minutes from the UW campus.

- **Union Cab:** (608) 242-2000
- **Badger Cab:** (608) 256-5566
- **Madison Taxi:** (608) 255-8294

Workshop Location

University of Wisconsin-Madison Pyle Center

The meeting will take place in the University of Wisconsin Pyle Center at

702 Langdon Street
Madison, WI 53706, USA



Walking directions from the Concourse Hotel and the Lowell Center

The Pyle Center is located on the eastern end of the university campus. It is a 15-minute walk from the **Madison Concourse Hotel** if you walk along State Street and just a block away from the **Lowell Center** along Langdon St.

From the Madison Concourse Hotel

Total distance to the Pyle Center: 1.1 km (0.7 mi)

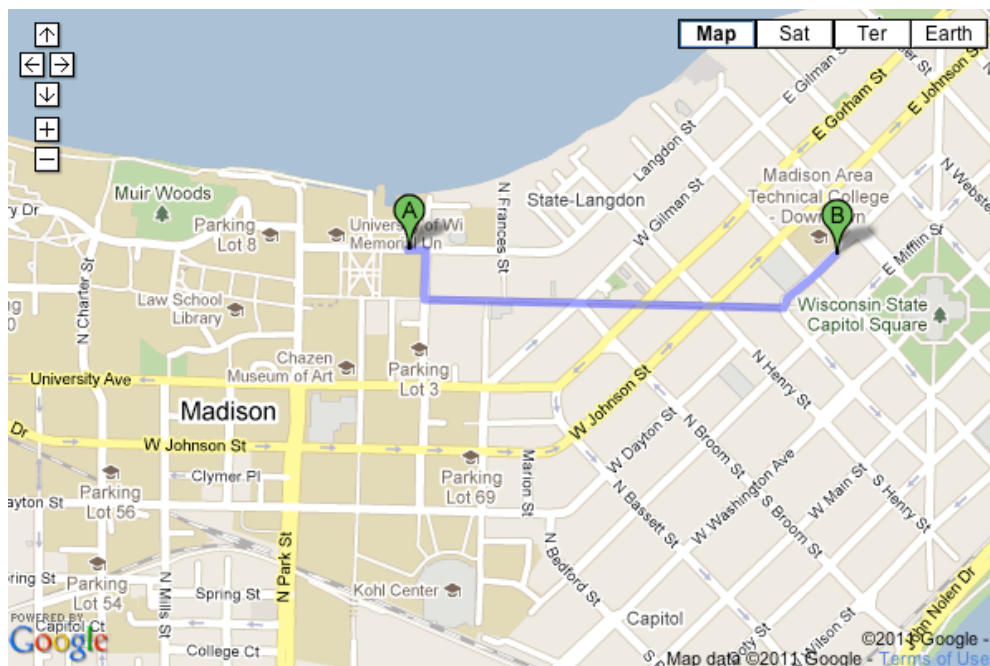

From the Lowell Center

Total distance to the Pyle Center: 160 m (530 ft)

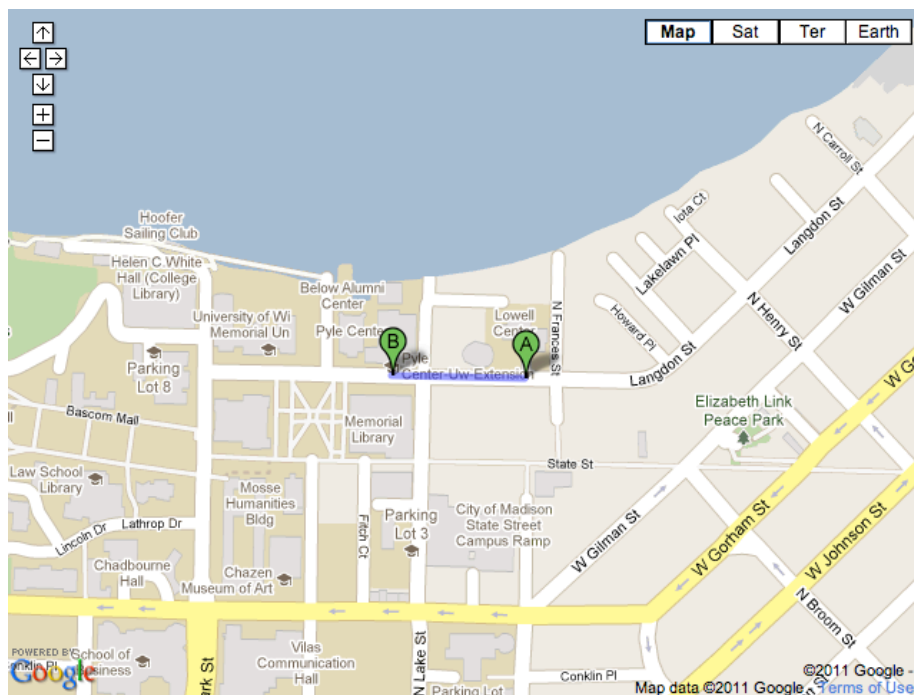

Room Location for the Workshop in the Pyle Center

The workshop will be held in **Room 309** on the third floor of the Pyle Center. To get to the room, enter the first floor of the Pyle Center through the **entrance on Langdon St**, and proceed to the third floor

using the elevators located on the right side of the main lobby. Room 309 is right across the hallway from the elevators on the third floor.

First Floor

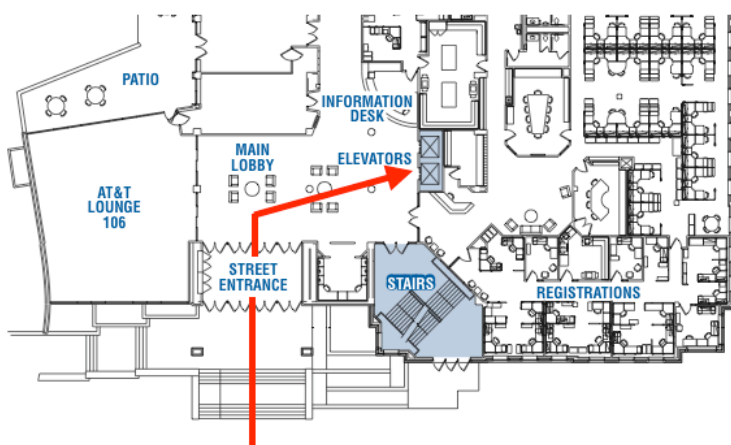

Third Floor



Lodging

Conference lodging is available at two places:

Madison Concourse Hotel

- **Address:** 1 W Dayton St
- **Phone:** +1 800 356 8293
- **Rate:** 70 USD (for workshop participants)

Make sure to mention that you're participating in an **IceCube workshop** in order to get the reduction in the rate. In case you're unable to book a room in this way, you may contact **Kim Kreiger** (kim.kreiger@icecube.wisc.edu) and work out the details with her in order to get a room.

Lowell Center

- **Address:** 610 Langdon St
- **Phone:** +1 866 301 1753
- **Rate:** 89 USD (Standard) or 105 USD (Deluxe) – Reservation code: COSMIC

Workshop Banquet

The workshop banquet (the price of which is already included in your registration fee) will be held at 7:30 PM (check webpage for any updates), Friday 28th at **Harvest Restaurant**, located on 21 N. Pinckney St, across the street from the Capitol Square. (See map on last page for location)

Map of downtown Madison

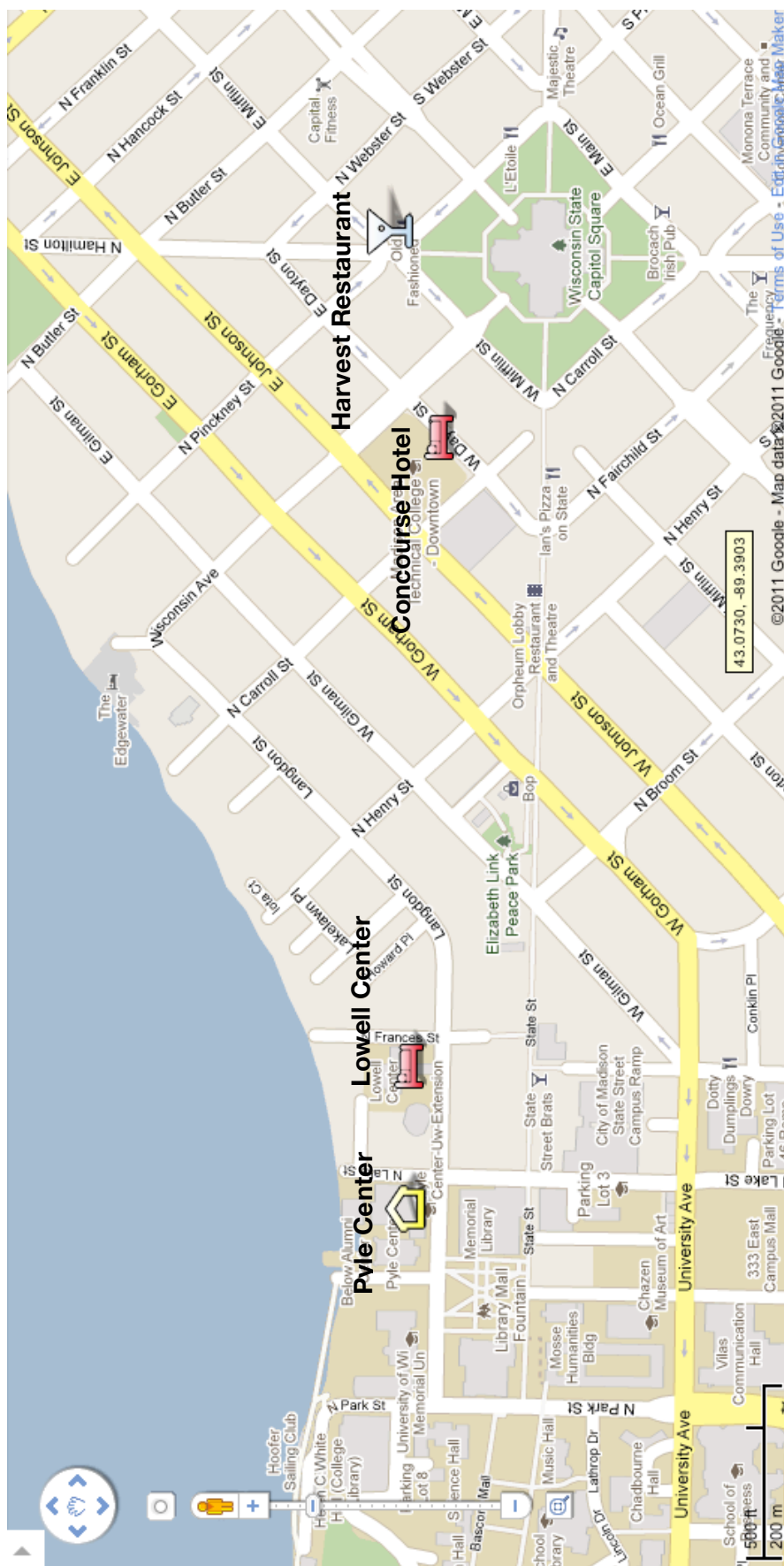

Pyle Center: 702 Langdon St
Lowell Center: 610 Langdon St

Harvest Restaurant: 21 N Pinckney St
Concourse Hotel: 1 W Dayton St